

# Quilted mat instructions

## Finished size

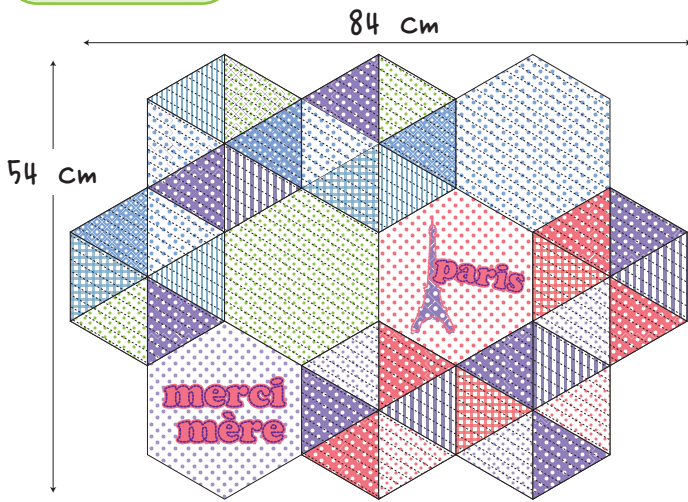

## [Materials]

	Height	Length
☆ Patterned fabric g, j and k	16 cm	26 cm
☆ Patterned fabric a, d, f, h and i	16 cm	34 cm
☆ Patterned fabric b and e	16 cm	42 cm
☆ Patterned fabric c	16 cm	66 cm
☆ Patterned fabric l, m, n and o	30 cm	26 cm
Backing	68 cm	92 cm
Quilt batting	68 cm	92 cm

☆ Adjust the pattern as desired.

☆ This design contains an appliqué, whose materials are not included in the above list.

## Cutting guide

Cut out the specified number of each piece.

\* Normally, pieces are sewn with their right sides together.

The pieces can be sewn together smoothly if the markings are on the wrong side of the fabric.

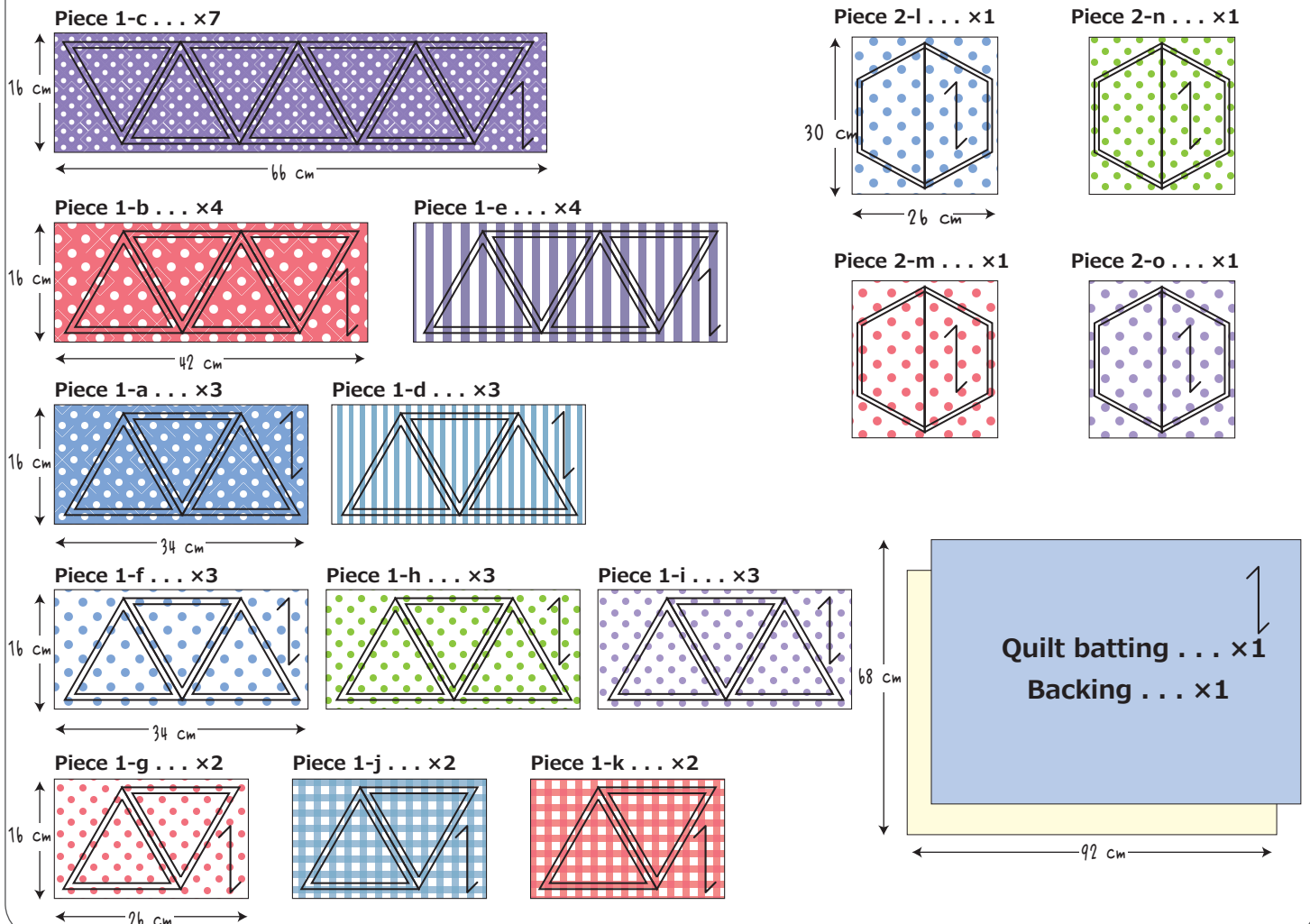



Make appliqué pieces!

Let's use the ScanNCut!

\* If you do not own a ScanNCut,  
create your own favorite appliqué.

Scan a design to  
make appliqué pieces.

- ① Prepare the design to be scanned.
- ② Touch the "Scan" key in the home screen to select the scanning mode. (Fig. ①)  
In the scanning mode selection screen, select "Scan to Cut Data".
- ③ Attach the paper (design) to the mat. (Fig. ②)  
While holding the mat level, lightly insert it into the feed slot, and then press  in the operation panel. (Fig. ③)

- ④ Press the "Start/Stop" button  to start scanning.

After the scanned image appears in the screen,

touch  to create cutting lines. (Fig. ④)

 Outline detection

 Region detection

 Line detection

- ⑤ Affix the specially designed iron-on fabric appliqué contact sheet to the appliqué fabric. (Fig. ⑤)  
Attach the fabric to the cutting mat.  
Use the included spatula to firmly attach the fabric so that there are no wrinkles or air bubbles.

#### Note

In order to prevent dust from attaching to the cutting mat, peel off the protective sheet immediately before attaching the fabric to be cut.

 ①

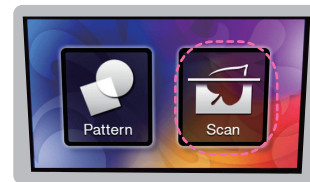

Select "Scan".

Fig. ②

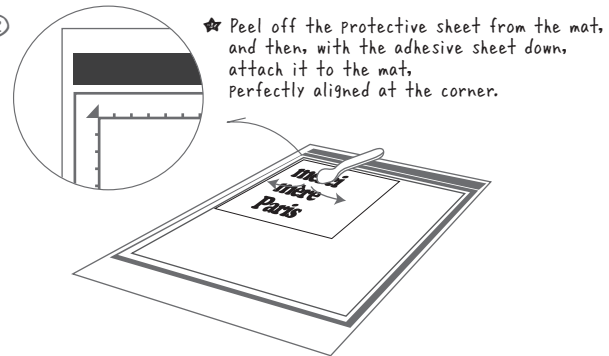

Fig. ③



Check the image to be scanned, and then touch the "OK" key.

★ The ScanNCut specifications may differ depending on the country where it was purchased.

Fig. ④

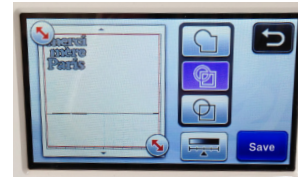

Select the region detection option.

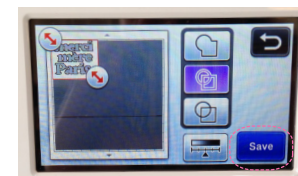

In the image trim screen, trim the regions of the pieces, and then save the data.

Fig. ⑤

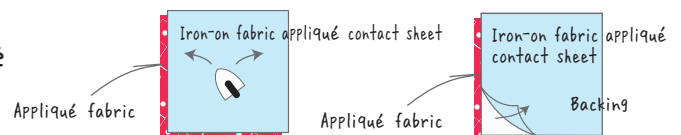

★ Affix the iron-on fabric appliqué contact sheet to the fabric so that no air is trapped between them.

★ After the fabric cools, peel off the backing.

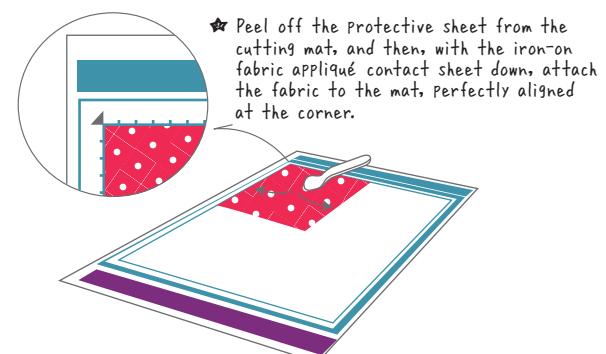

⑥ Insevt the mat. (Fig. ⑥)

While holding the mat level, lightly insert it into the feed slot, and then press  in the operation panel.

Fig. ⑥



★ After the mat is fed into position, it is ready to begin cutting.

⑦ Make the cuts.

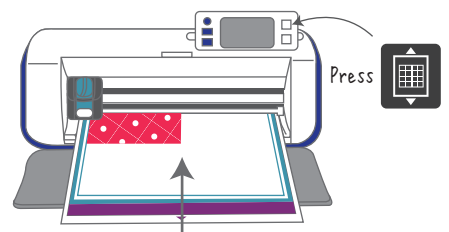
In the draw/cut selection screen, select "Cut". (Fig. ⑦)

Press the "Start/Stop" button  to start cutting.

When cutting is finished, press  in the operation panel to feed out the mat, and then use the included spatula to peel off the pieces.

Fig. ⑦



Select "Cut", and then press the "Start/Stop" button.

★ First peel off the surrounding excess fabric, and then use the spatula to carefully peel off the piece.

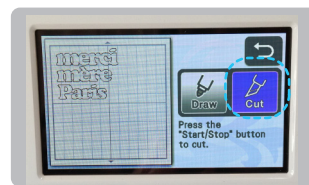
★ Simplified descriptions of the scanning and cutting procedures are provided here. For details, refer to the Operation Manual.

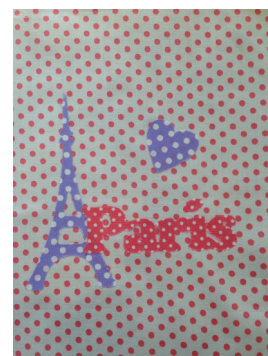
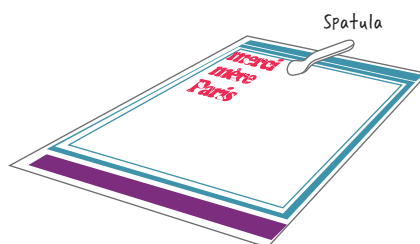

The appliqué pieces are finished!

## Step ①

### Making the hexagonal pieces.

- ① Attach the appliques and embellishments to pieces 2-o and 2-m, and then sew them with decorative stitching. (Fig. ⑧)

**Note**

If appliques or embellishments will be used, attach them at this stage.

- ② Sew together pieces 1 to create hexagons.  
With right sides together, sew one piece 1 to another.  
Press the seam, folding the seam allowances over to one side.

(Fig. ⑨-a)

**Note**

- Leave a seam allowance; do not sew along the edge of the fabric.
- By folding over the seam allowance, a cleaner finish can be achieved.

- ③ With right sides together, sew on another piece 1, and then create another section of three pieces 1 sewn together.  
Press the seams, folding the seam allowances over to one side.

(Fig. ⑨-b)

- ④ With right sides together, sew one section of three pieces 1 sewn together to another.  
Create all six hexagons in the same way. (Fig. ⑨-c)

Fig. ⑧



Fig. ⑨-a

\* Refer to the image of the finished Project for the color scheme of the Pieces.

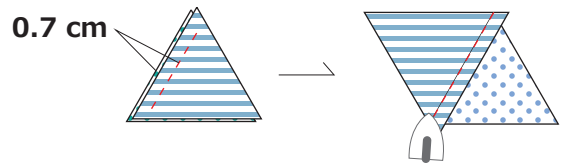

Fig. ⑨-b

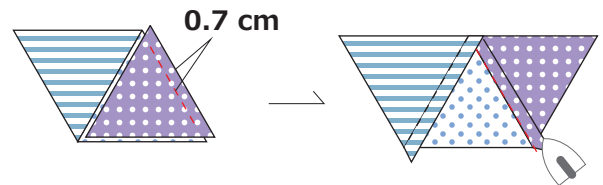
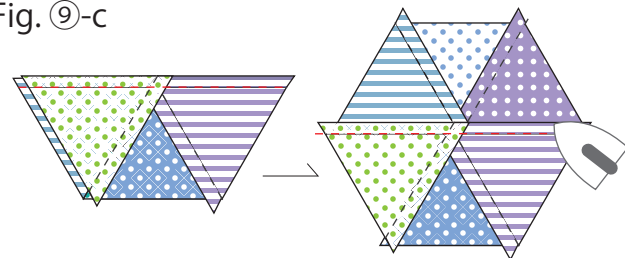

Fig. ⑨-c



## Step ②

### Sew together hexagonal pieces.

- ① Sew together the hexagonal pieces to form linked hexagons. (Fig. ⑩)  
With right sides together, sew one hexagon to the one beside it.  
Sew together three hexagons for row 1, four for row 2, and three for row 3.

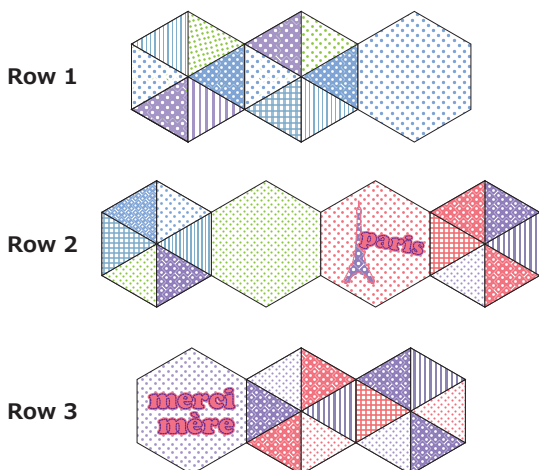
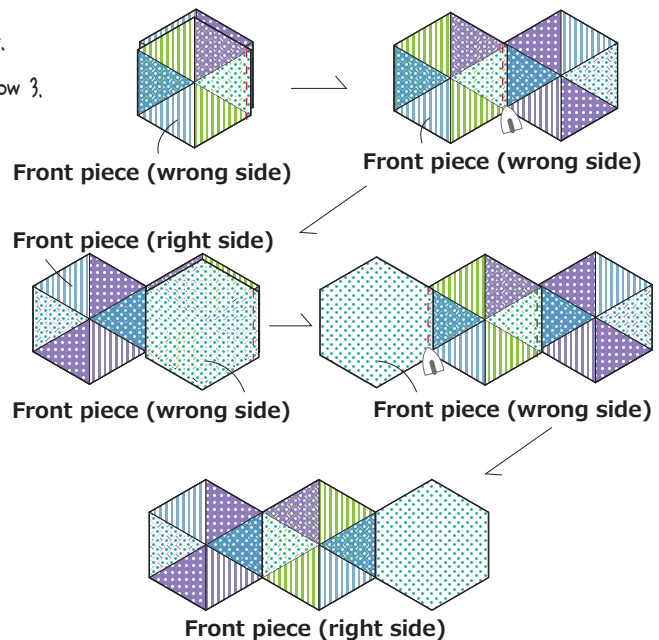

Fig. ⑩



- ② With right sides together, sew row 1 to row 2, zigzagging from corner to corner, along the hexagon sides to be joined. At this stage, make sure that the corners of matching pieces do not become misaligned. Press the seams, folding the seam allowances over to one side. (Fig. ⑪)

**Note**  
In order to prevent misalignments, insert pins at corners, where the stitching direction changes.

Fig. ⑪

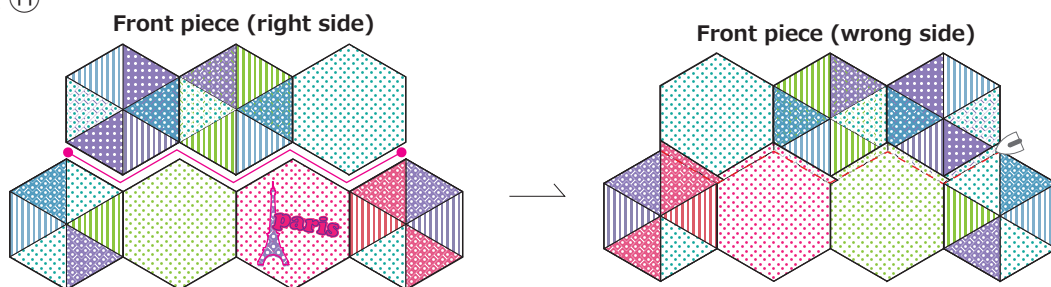

- ③ Sew row 2 to row 3 in the same way. Turn the fabric over to the right side, and then press it. (Fig. ⑫)

Fig. ⑫

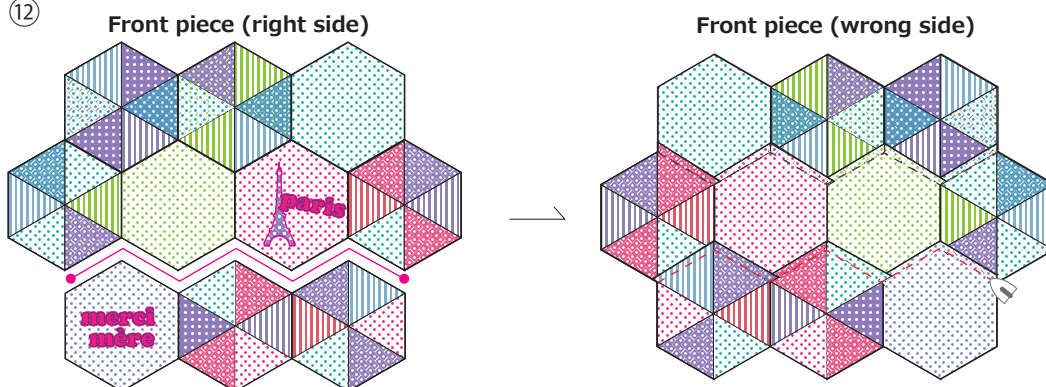

**Step ③**

Sew quilting.

- ① Mark the quilting lines on the joined pieces. (Fig. ⑬)  
At an angle 60° from the vertical, draw lines at 1.5 cm intervals parallel to the hexagon edges. (Draw marks using a chalk pencil, etc., so that they can easily be removed later.)

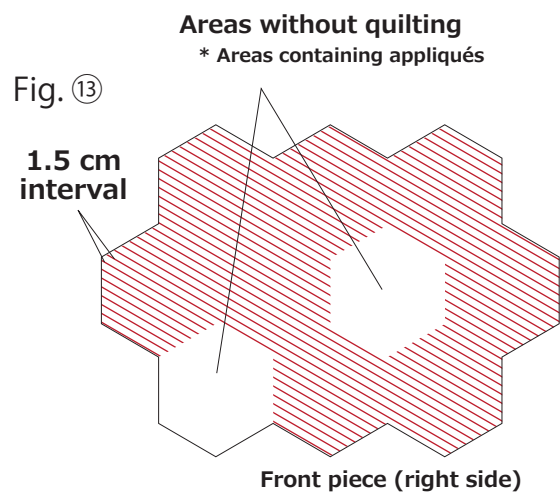



② Baste the joined pieces and the quilt batting so they do not become misaligned.

Sew the quilting in the order ① through ⑤. (Fig. ⑭)

When an area without quilting is reached, sew reinforcement stitches to secure the stitching. Be sure to continue the quilting in the same direction. Sew carefully to avoid misaligned quilting. After stitching, press the seams.

**\* Optional attachment**

For best results, use a walking foot and quilter, etc.

Fig. ⑭ [Sewing quilting]

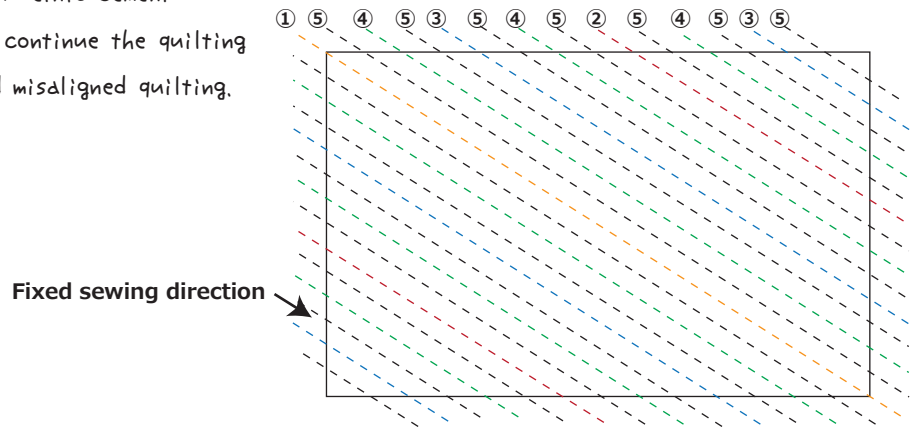

**Step ④**

Attach the backing.

- ① Measure the size of the hexagon piece, and then cut out the backing with a 0.7 cm seam allowance. With right sides together, sew the top piece to the backing, leaving an opening. (Fig. ⑮)

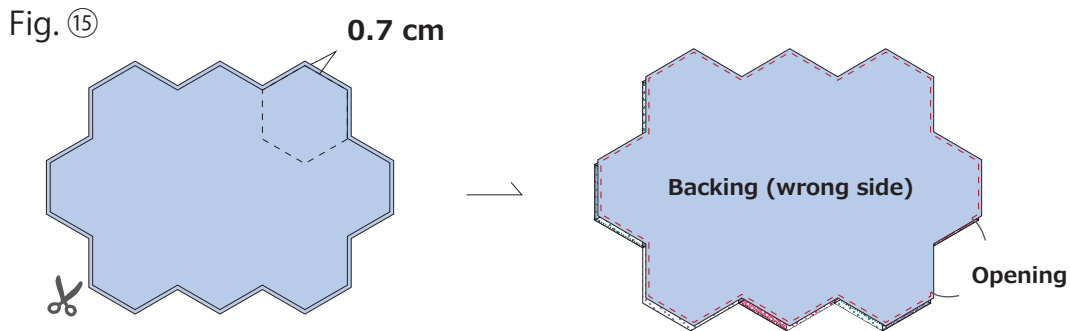

- ② Press the seams, and then turn right side out. Close the opening with blind hem stitches. (Fig. ⑯)
- Stitch 0.7 cm from the edge, all around.

**Note**  
When turning right side out, an awl may be useful for turning out the corners.

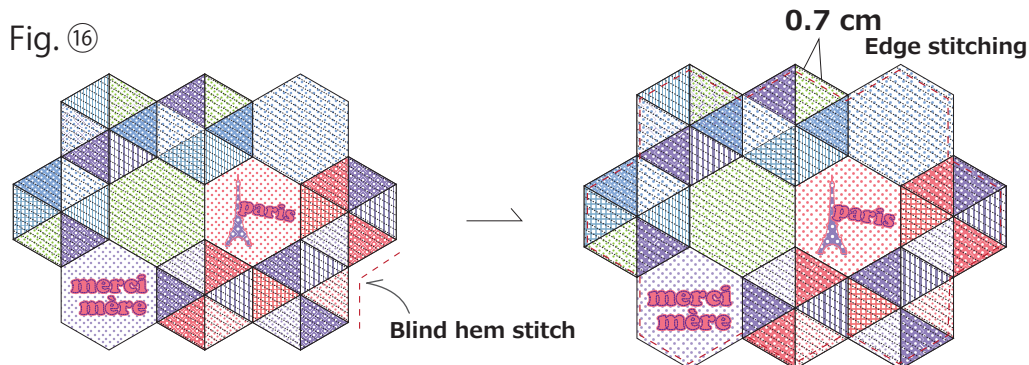

# ☆ Finishing

Touch up with an iron, and you are finished! (Fig. ⑰)

Fig. ⑰

